

Revisions			
Rev	Date	Description	By

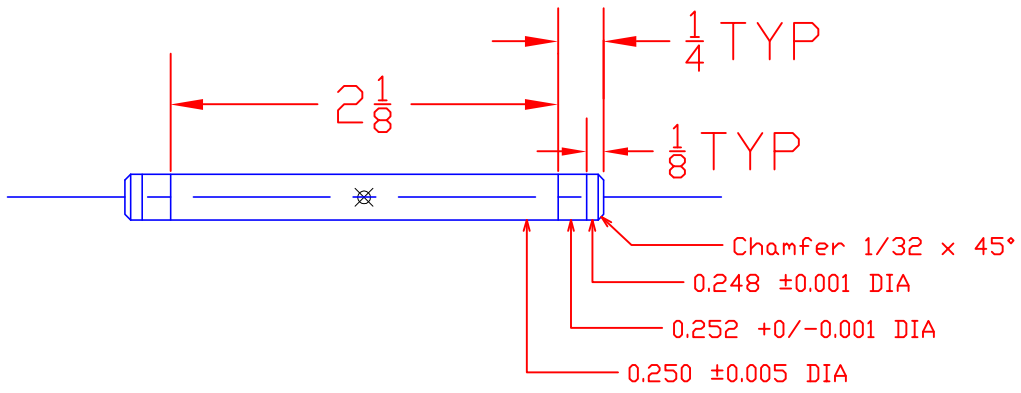

-111 Screw Handle, LC - Shown
 -211 Screw Handle, Brass - Same as -111 except as noted

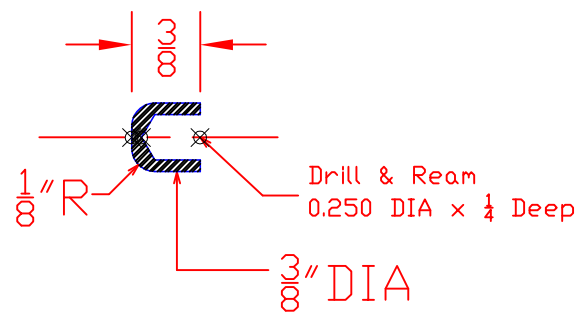

-113 Cap, LC - Shown
 -213 Cap, Brass - Same as -113 except as noted

	-213	Cap, Brass			3/8 DIA x .5" long
△	-113	Cap, LC	1018 LC/CF Steel		3/8 DIA x .5" long
	-211	Screw Handle, Brass			1/4 DIA x 2.75" long
△	-111	Screw Handle, LC	1018 LC/CF Steel		1/4 DIA x 2.75" long
	Part No.	Description	Material	Specif.	Stock Size

Tolerances Unless Otherwise Noted		ETSU Technology		
Decimal xxx : +/- 0.005 xx : +/- 0.03 x : +/- 0.1		U-Clamp Assembly		
Fractional +/- 1/64		Screw Handle & Cap, Details of		
Angular +/- 0.5 Deg		Dwgn by C H Flint	Date	
		NTS	01/10/21	
		Drawing No.	Rev	Sheet
		2170-013-54	-	1 of 1