

Revisions			
Rev	Date	Description	By
A	99-1-11	Revised Note 1-4; Title Block, BOM & Parts Call-outs	W/KH
B	2014JAN08	COMPLETELY REDRAWN	W/KH

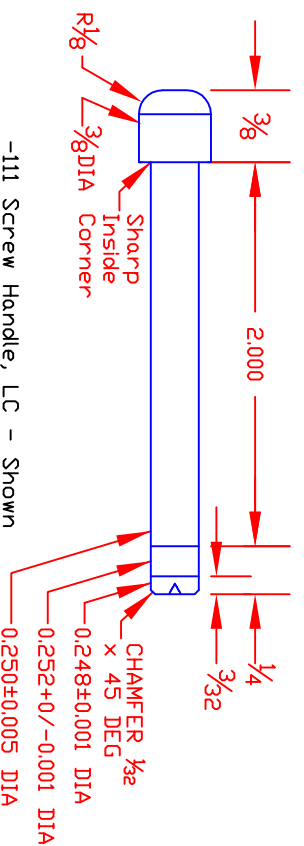

-111 Screw Handle, LC - Shown
 -211 Screw Handle, Brass-
 Same as -111 except per BOM

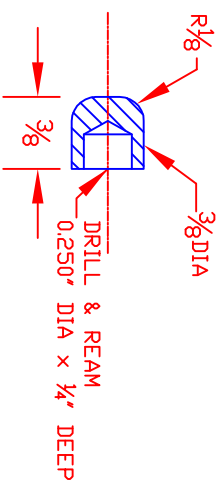

-113 Cap, LC - Shown
 -213 Cap, Brass-
 Same as -113 except per BOM

Notes:

- 1 Deburr/break all sharp edges
- 2 Apply preservative to part after fabrication
- 3 Manual fabrication IAW Rpt. LPI-2200-01 [Clamp]
- 4 CNC: Use CNC Pgrm 2200-54.cnc Setup I.A.W. Rpt. 2200-54.doc

Part No.	Description	Material	Specif	Stock Size
-213	Cap, Brass	CA 360 Brass	ASTM B16	3/8" DIA Rod x 3/8"
-113	Cap, LCI	1018 LC/CF Stl	MIL-S-11310	3/8" DIA Rod x 3/8"
-211	Screw Handle, Brass	CA 360 Brass	ASTM B16	3/8" DIA Rod x 2-5/8"
-111	Screw Handle, LC	1018 LC/CF Stl	MIL-S-11310	3/8" DIA Rod x 2-5/8"

Tolerances

.x ±.1
 .xx ±.03
 .xxx ±.005
 Fractional ±1/16
 Angular ±.5°

Unless otherwise noted

ETSU - ENTC 2200

Dwg Name
 C-CLAMP ASSEMBLY
 SCREW HANDLE & CAP, DETAILS OF

Size	Date	Dwg No	Rev
A	2014JAN08	2200-54	B
Scale	NTS	Dwg by	B. HEMPHILL